

# b-square book/1

bookshelf lighting

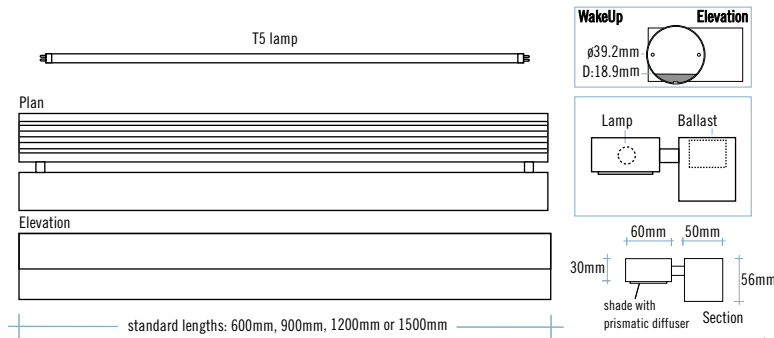

B-square/book/1



B-Square / Book / Integral Ballast

## B-SQUARE/1/BOOK

Design: Aktiva, 2006

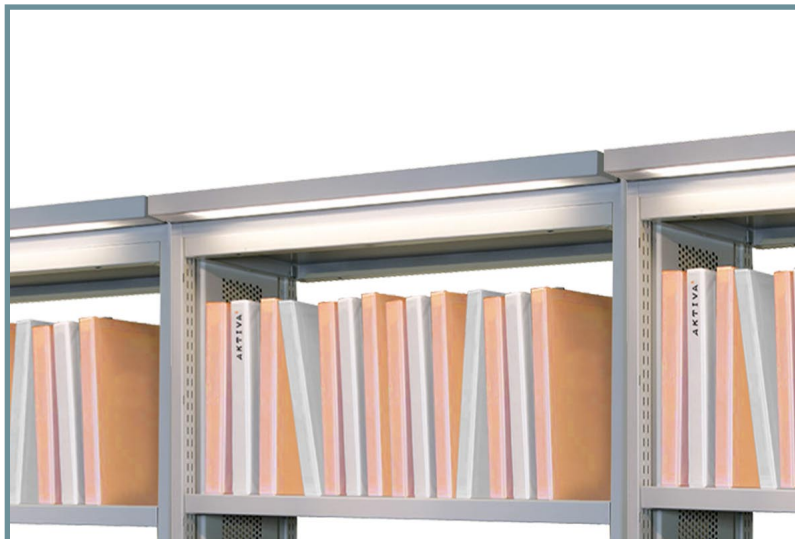

B-square/book/2 Integral Ballast

An economical plug-in lighting system designed to fit all static and mobile metal bookshelves. Sizes and fixings tailored to manufacturers requirements. Light output can cover both shelves and aiseways. Capital costs, installation costs and running costs minimised.

### FEATURES

Excellent bookshelf and aisleway fluorescent illumination with High Output T5 Lamping  
 Suitable for mobile bookshelving  
 Plug-in units minimise installation costs  
 Passive microwave detector for minimising running costs  
 Design tailored to fit particular shelving system

### OPTIONS

/adj	adjustable stabiliser to prevent sagging where extra long stems used
/b-line	system may use b-line fitting
/dim1	analogue 1-10v dimmable electronic ballast
/dim2	digital/DALI dimmable electronic ballast
/e	fixing to allow non standard length stems
/emergency	3 hours maintained
/length	as per manufacturers' module length
/support stem	16mm - 200mm (standard 200mm)
/special stem	200mm - 400mm
/...W t5	24 - 80 Watt High Output t5 fluorescent lamp
/WakeUp1	microwave timing/sensitivity adjustable presence detector for economy control of area or aisleway installations
/WakeUp2	passive infrared ray (PIR) timing/sensitivity adjustable presence detector for economy control of area or aisleway installations



Mobile Shelving/Cowdray House  
/London School of Economics

B-square/book/2



WakeUp - microwave presence detector

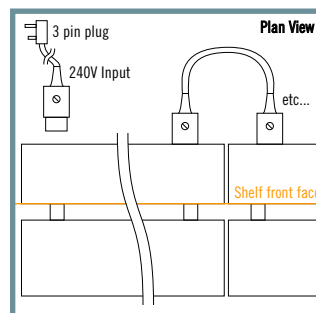

Plug-in system between modules