

# b-line LED bookshelf lighting

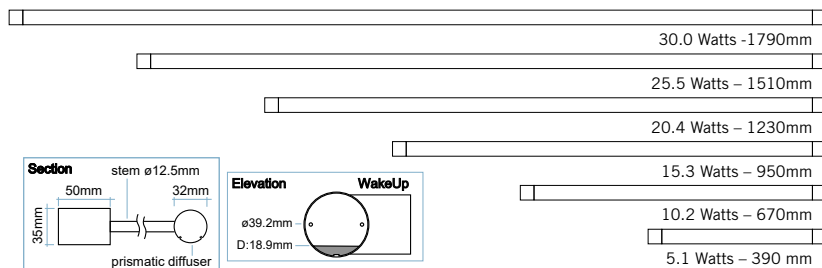

b-line/LED/book/integral35 dimensions  
 WakeUp dimensions

b-line/LED/book



b-line/LED/Book top detail - brushed stainless steel effect

## B-LINE/LED/BOOK

Design: Aktiva, 2012  
 Manufacture: Aktiva, London

High performance high efficiency slim  $\varnothing$ 32mm LED fitting for bookshelf applications. Features include facility to join b-line in multiples, lockable shade adjustment, 3000°K & 4000°K colour temperature as standard plus 3 further options. 90+ CRI colour rendering option also offered.

### LED

Linear LED producing highly efficient 121 lumens per Watt\* with standard 30° PMMA satin lens. Available in White 3000°K & Cool White 4000°K. LED CRI: 82 - 84. 90+ CRI also available.

\*based on 3000°K LED excl driver consumption. 10% output decrease after 50,000 hrs. LED Boards running at  $t_c=65^\circ\text{C}$

### 350mA

Standard current output for all applications. Optional 500mA and 700mA available for special requirements.

Length	Wattage	Voltage (d.c)	Total Luminous Output	
			3000°K	4000°K
390 mm	5.1 W	15 V	590 lm	627 lm
670 mm	10.2 W	30 V	1179 lm	1254 lm
950 mm	15.3 W	45 V	1769 lm	1882 lm
1230 mm	20.4 W	60 V	2358 lm	2509 lm
1510 mm	25.5 W	75 V	2948 lm	3136 lm
1790 mm	30.6 W	90 V	3538 lm	3763 lm

### DRIVERS

aktvs 350.009	ECXe 11W driver 390mm b-line/LED
aktri TALEXconverter	LCI 20W 350mA TEC SR 670mm and 950mm b-line/LED
aktri TALEXconverter	LCI 35W 350mA TEC SR 1230mm and 1510mm+ b-line/LED

Dimmable drivers available see Options

### OPTIONS

/book/integral	boxed driver top mounted on bookshelf
/book/remote	remote driver with various fixing options (see below)
/colour temperature	very warm white 2700°K optional warm white 3000°K standard cool white 4000°K standard cool white 5000°K optional daylight 6500°K optional
/CR90+	high colour rendering LED
/curved	curved shade as special order
/desk	desk and workstation applications
/dim1	analogue 1-10v dimmable driver
/dim2	digital/DALI dimmable driver
/dim3	phased dimmable mains driver
/display	wall and display applications
/e3	fixing to allow non standard length stems
/emergency	3 hour maintained remote or integral
/f1/e3	$\varnothing$ 40mm surface/wall fixing
/f2/e3	$\varnothing$ 76mm surface fixing
/integral35	integral driver & box d:35mm w:50mm
/multiple	x2 x3 x4..... in continuous run
/support arms	16mm - 200mm (standard: 200mm)
/unit length	shade/s cut to special lengths
/w1	$\varnothing$ 22mm through-panel washer fixing
/WakeUp1	microwave integral presence detector for automatic on/off control
/WakeUp2	infrared integral presence detector for automatic on/off control
/wired	plug/socket light-to-driver-mains wiring system custom designed to facilitate on-site installation

### FINISHES

Coated: Matt Silver, White  
 Plated: Brushed Stainless Steel Effect, Polished Chrome, Polished Brass  
 Special finishes (including bronze coated) on request

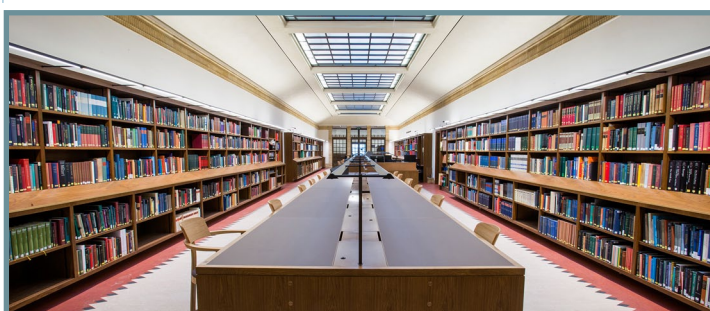

Weston Library Oxford/Wilkinson Eyre Architects

b-line/LED/book and b-line/2by2Wave



b-line/LED lens detail - brushed stainless steel effect



The London Library Haworth Tompkins Architects + Arup Lighting

b-line/LED/book



UCL Hub Senate House London/BDP Architects

b-line/LED/book

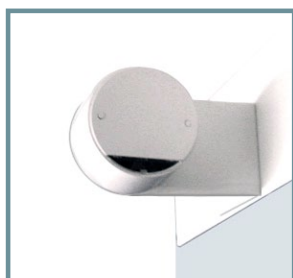

WakeUp - microwave presence detector

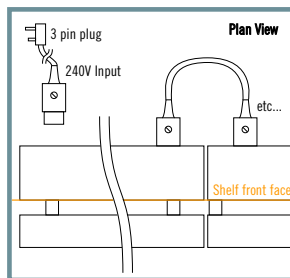

Plug-in system between modules

